

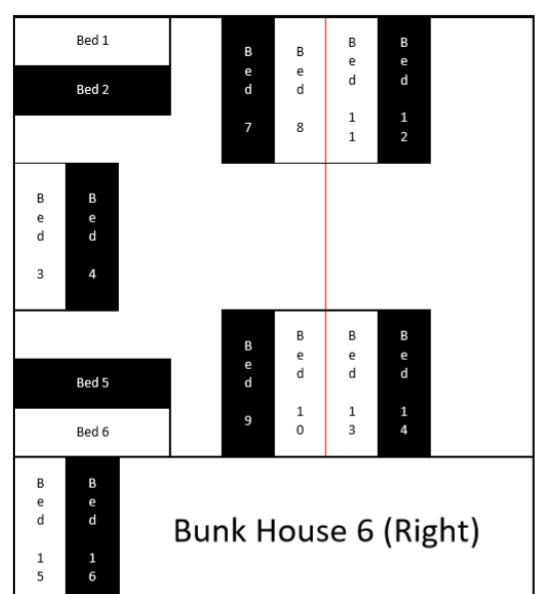

openlight

Campsite

Information for teachers

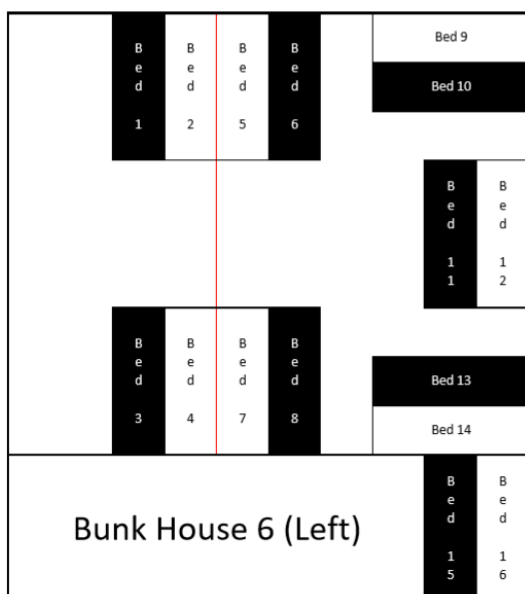
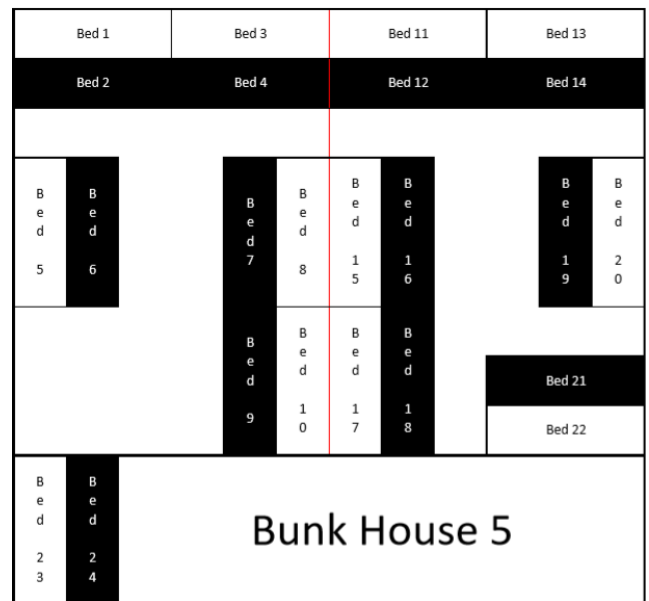
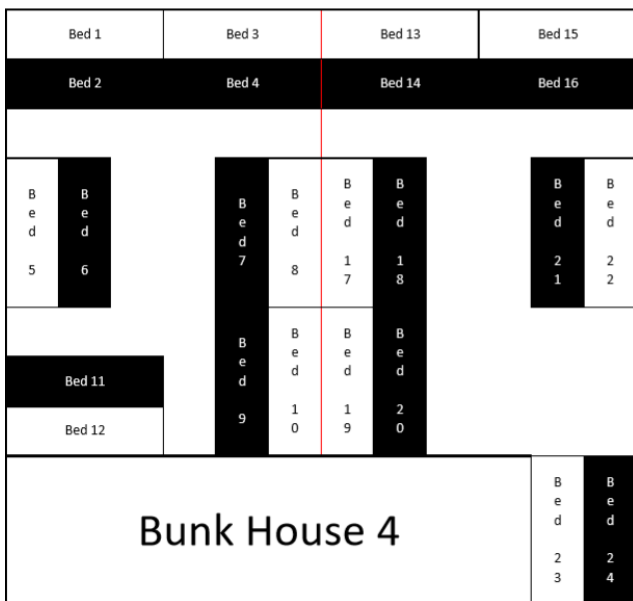



openlight Campsite

Information for teachers

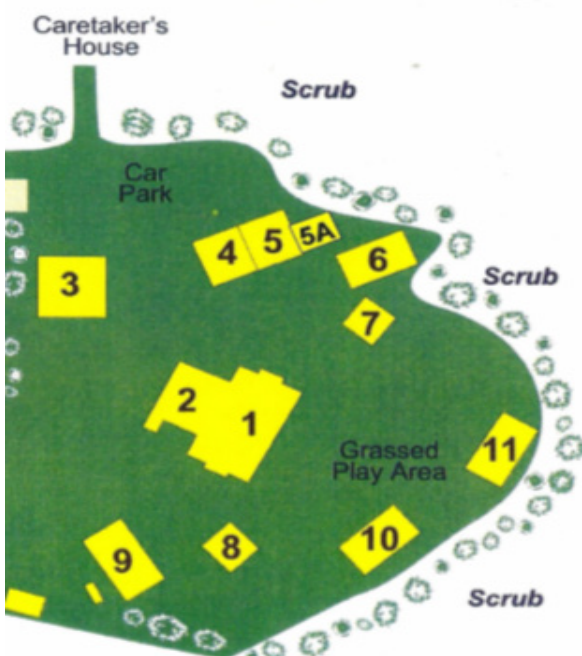
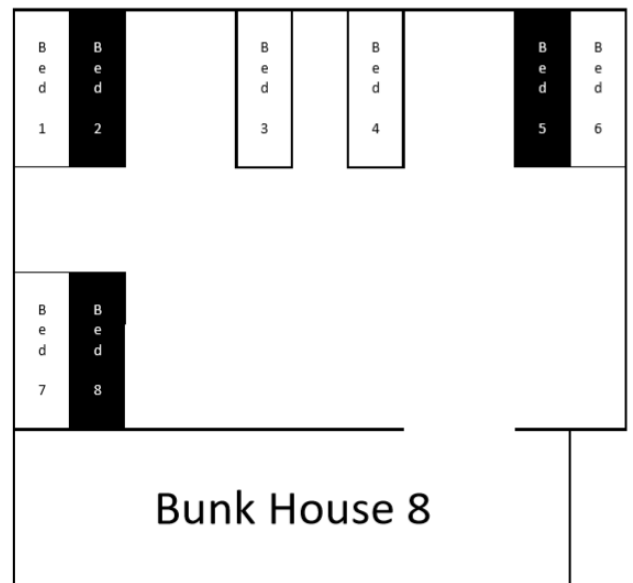
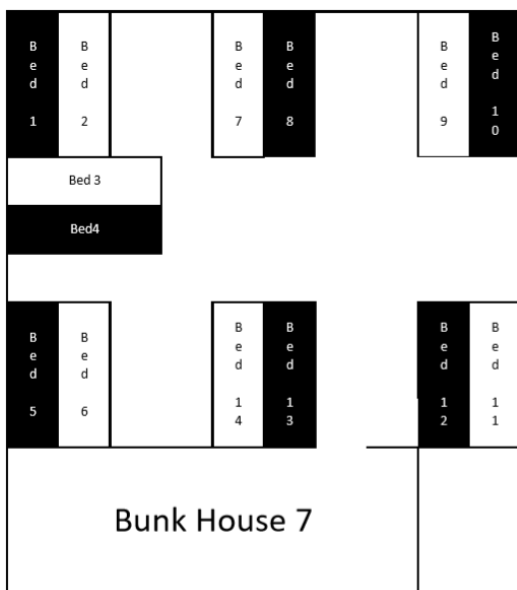

Site Map:

- 1) Main Hall
- 2) Kitchen
- 3) Toilet and Shower Block
- 4) Bunk House 4
- 5) Bunk House 5
- 5a) Disabled Shower and toilets
- 6) Bunk House 6
- 7) Bunk House 7
- 8) Bunk House 8
- 9) Recreation Room
- 10) Half Court
- 11) Volleyball Court